

5

THE NOTTOWAY TOWNHOUSE ASSOCIATION SECTION TWO

PARKING LOTS

The Deed of Dedication states that each unit has two parking spaces. Parking is enforced in accordance with the covenants in the Deed of Dedication. A plat is attached that gives an overview of the entire subdivision as well as individual clusters. Each parking space is numbered according to the house numbers in that cluster. You can easily see where your assigned spaces are located.

It is considered a violation of the covenants if any of the following occurs:

1. Any vehicle in a fire lane or parked in the entrance way to any lot.
2. Any vehicle parked in other than an assigned space.
3. Any vehicle double-parked.
4. Any vehicle parked on the grass including in common areas.
5. Any vehicle parked on sidewalks.
6. Any resident vehicle parked in a designated visitor parking space.
7. Any vehicle diagonally parked in a parking lot corner.
8. Any vehicle with missing or expired license plates or County stickers.
9. Any vehicle with missing or expired inspection stickers.
10. Any wrecked or otherwise inoperable vehicle.
11. Any vehicle that appears to be abandoned or stored on Nottoway property.

The Board of Directors will have a vehicle in violation towed, at the owner's expense. If your vehicle is towed, you will have to make arrangements with the towing company to pick up your vehicle. The towing service that the Board authorized is Henry's Wrecker Service, 804 North Royal Avenue, Front Royal, VA, phone number 540-635-5005. The towing company requires that the person who picks up the vehicle must be the registered owner with a current registration and a valid license. The Company also requires payment in cash for all towing and storage charges. Damage to the vehicle or missing items in the vehicle is at the owners risk.

Visitor parking is permitted in designated spaces and along the streets, where overflow resident parking is encouraged, but please be advised to remain off of the hard surfaces of the street to avoid accidents and/or traffic tickets. If you have more than two vehicles in your unit, you are advised to take immediate steps to have any excess vehicles parked in accordance with these rules. You are reminded that trailers, boats, or other non-personal vehicles or equipment are not permitted in any Nottoway community lot and are subject to towing.

Board of Directors

Nottoway Section Two

July 22, 2005

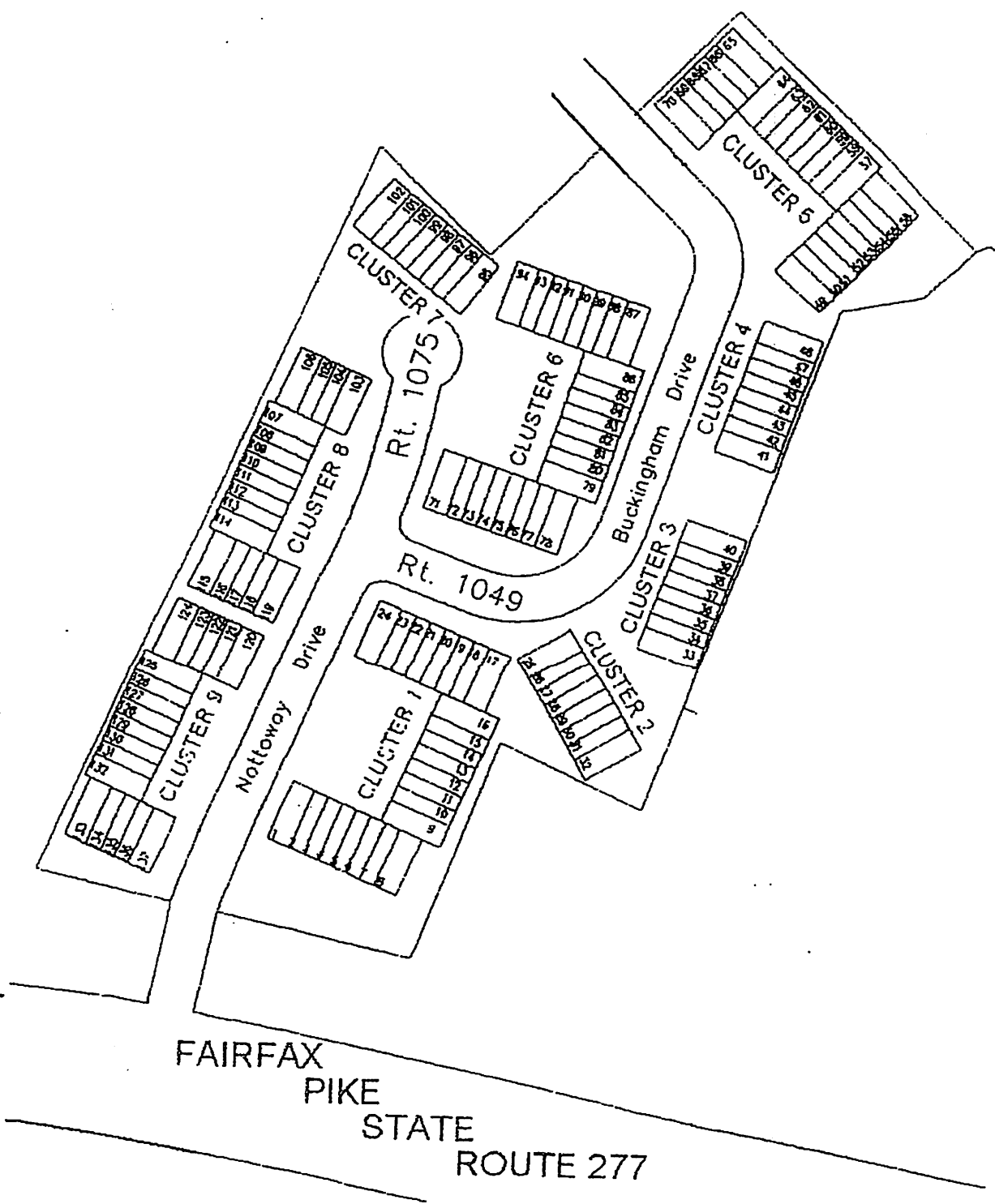

NOTTOWAY DRIVE

CLUSTER #1

Lots 001 thru 024

24 UNITS - 54 SPACES

July 22, 2005

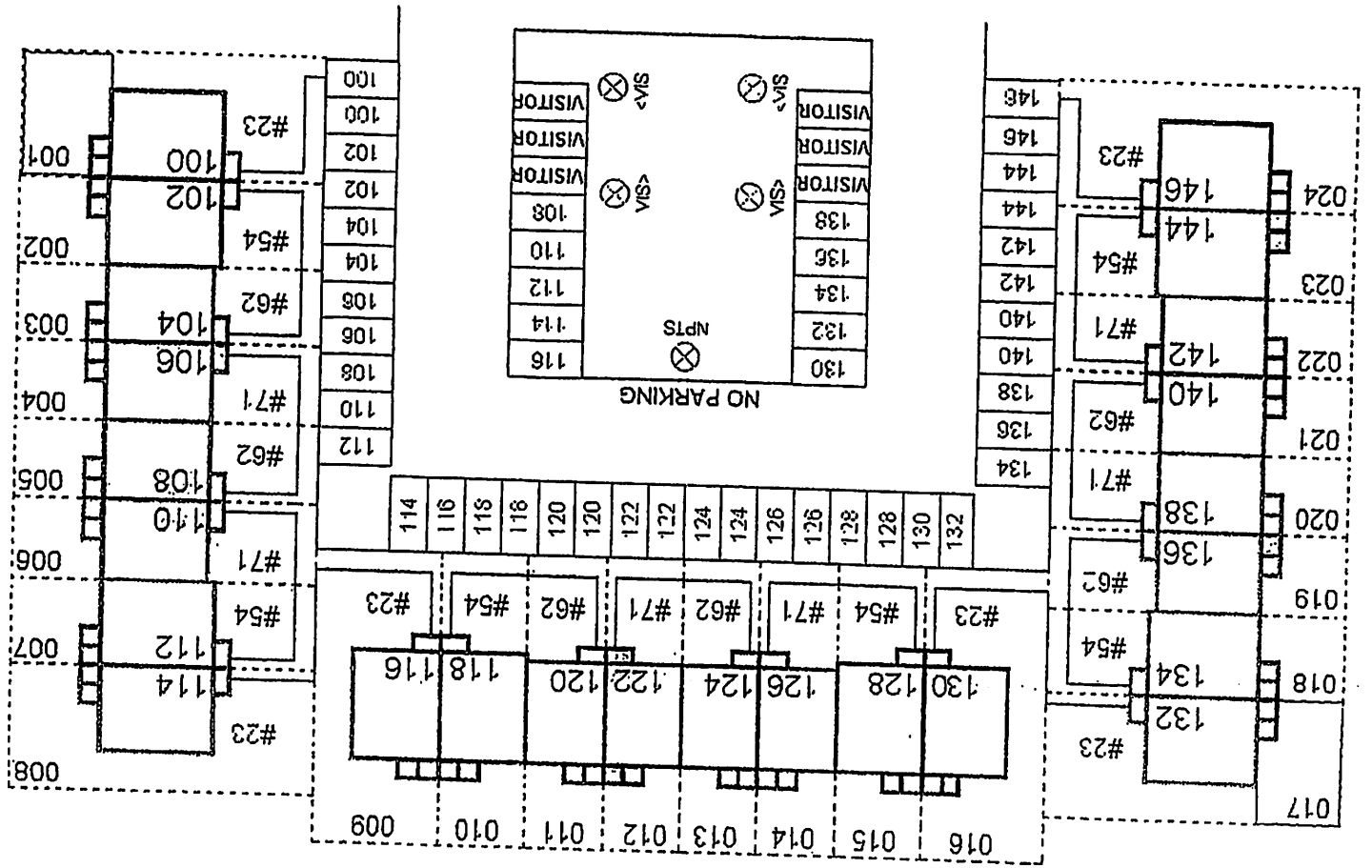

Homes shown shaded are Owner occupied
 Lots and decks shown shaded are those with
 Board approved fences and decks

3 PIXELS/FOOT

2

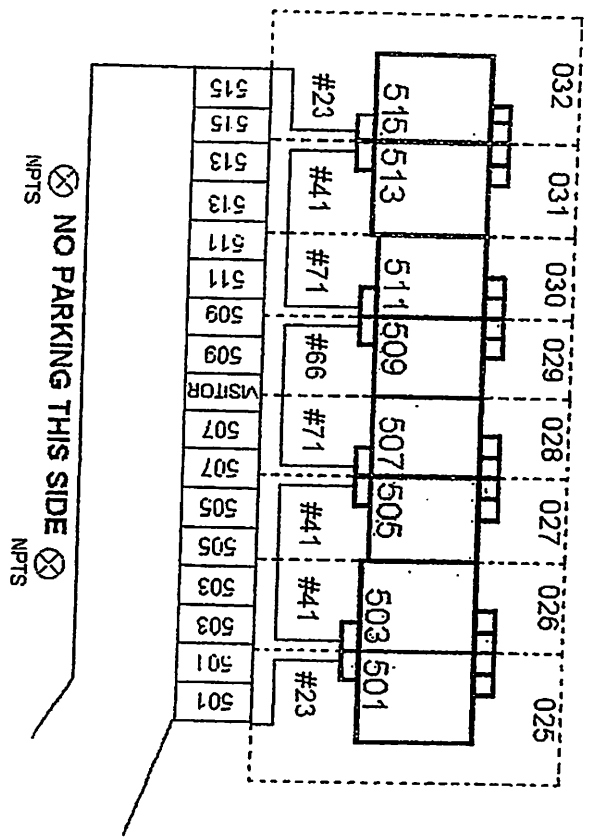

BUCKINGHAM DRIVE
CLUSTER #2
 Lots 025 thru 032
 8 UNITS - 17 SPACES

July 22, 2005

Homes shown shaded are Owner occupied.
 Lots and decks shown shaded are those with
 Board approved fences and decks.

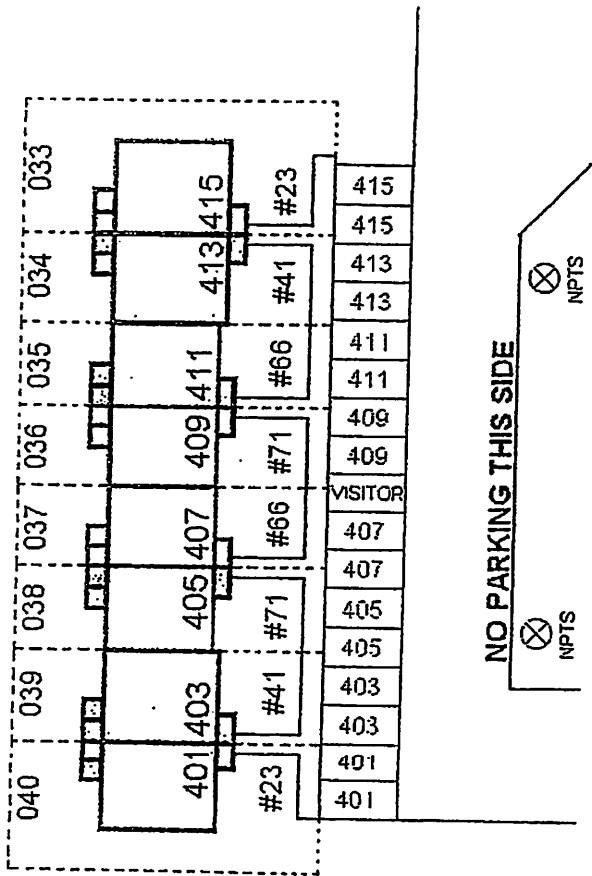

BUCKINGHAM DRIVE
CLUSTER #3
 Lots 033 thru 040

8 UNITS - 17 SPACES

July 22, 2005

Homes shown shaded are Owner occupied
 Lots and decks shown shaded are those with
 Board approved fences and decks

3 PIXELS/FOOT

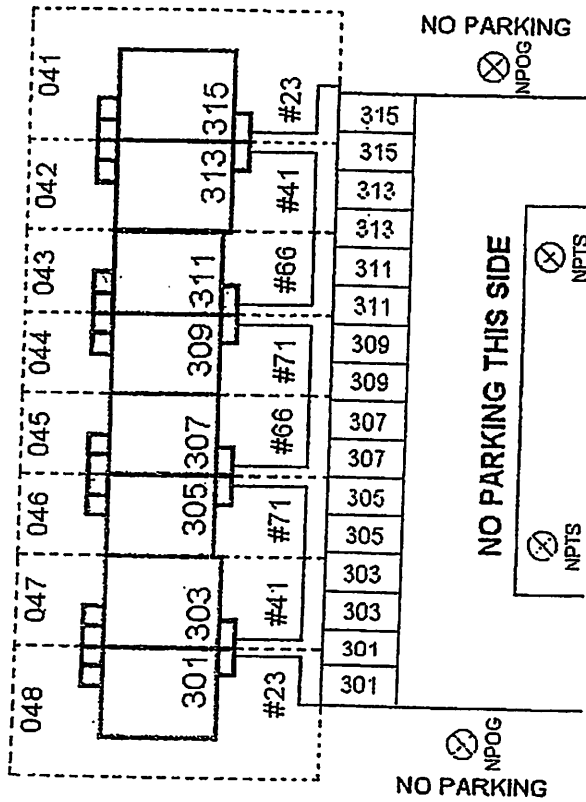

BUCKINGHAM DRIVE
CLUSTER #4
 Lots 041 thru 048
 8 UNITS - 16 SPACES

July 22, 2005

Homes shown shaded are Owner occupied
 Lots and decks shown shaded are those with
 Board approved fences and decks

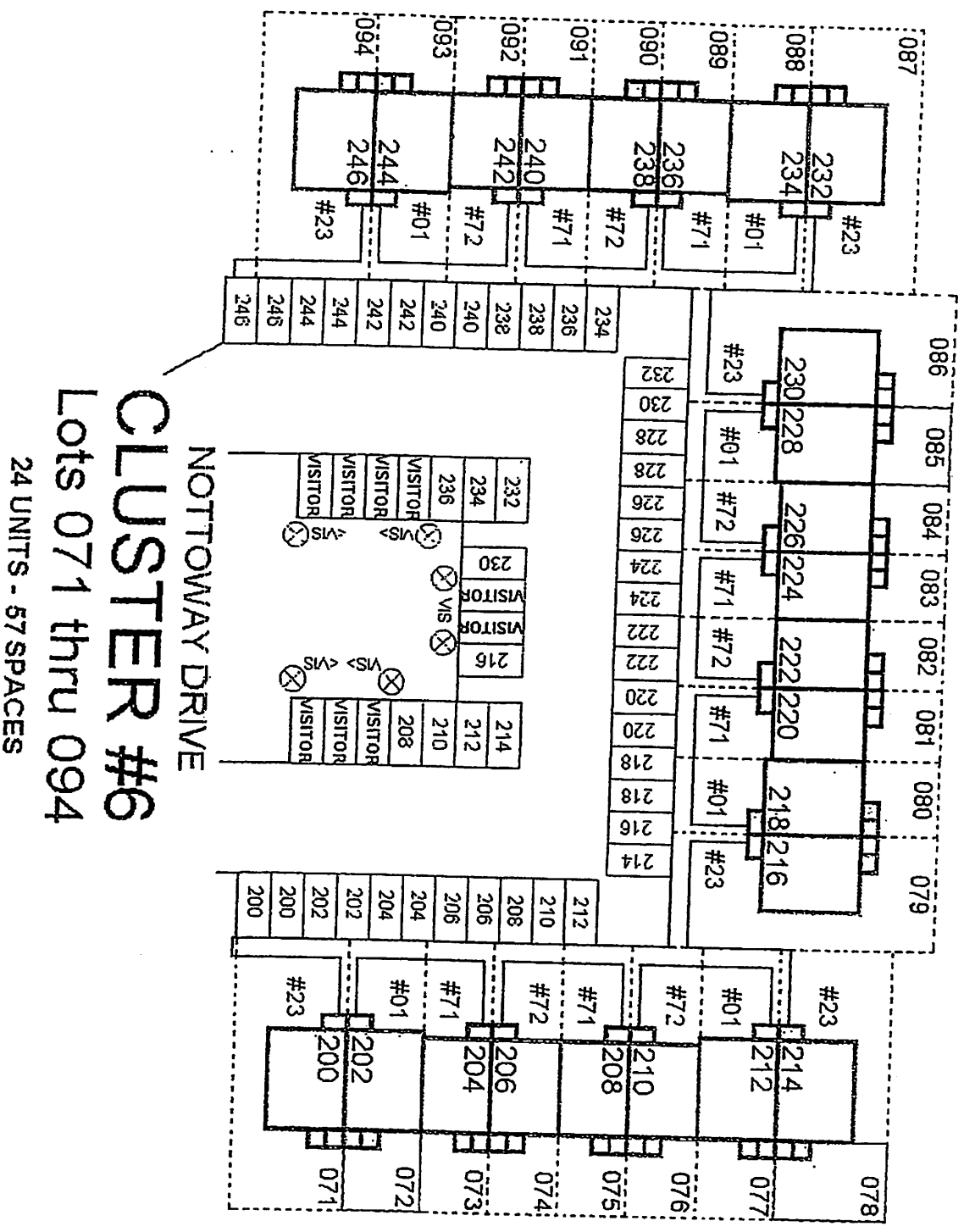

CLUSTER #6
Lots 071 thru 094

24 UNITS - 57 SPACES

July 22, 2004

Homes shown shaded are Owner occupied
 Lots and decks shown shaded are those with
 Board approved fences and decks

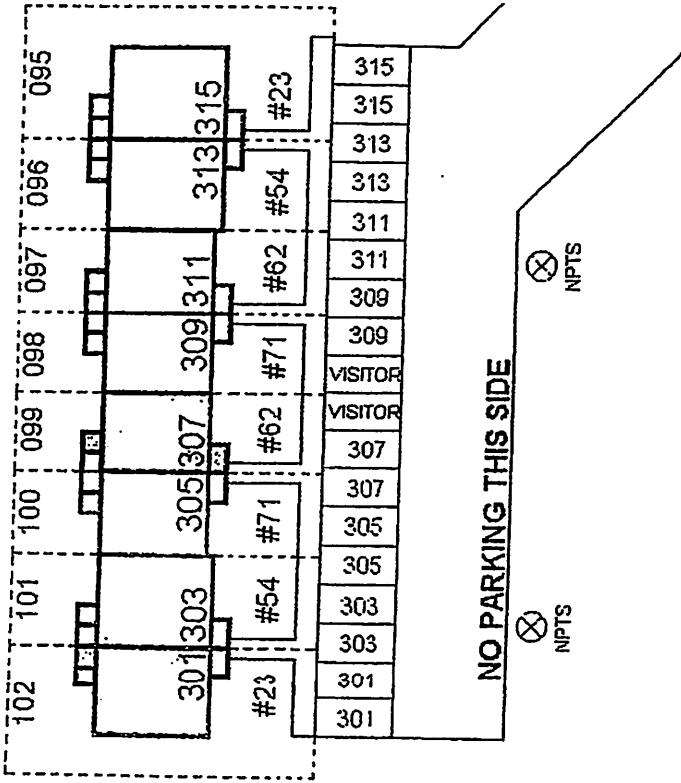

NOTTOWAY DRIVE
CLUSTER #7
 Lots 095 thru 102

8 UNITS - 18 SPACES

July 22, 2005

Hornes shown shaded are Owner occupied
 Lots and decks shown shaded are those With
 Board approved fences and decks

3 PIXELS/FOOT

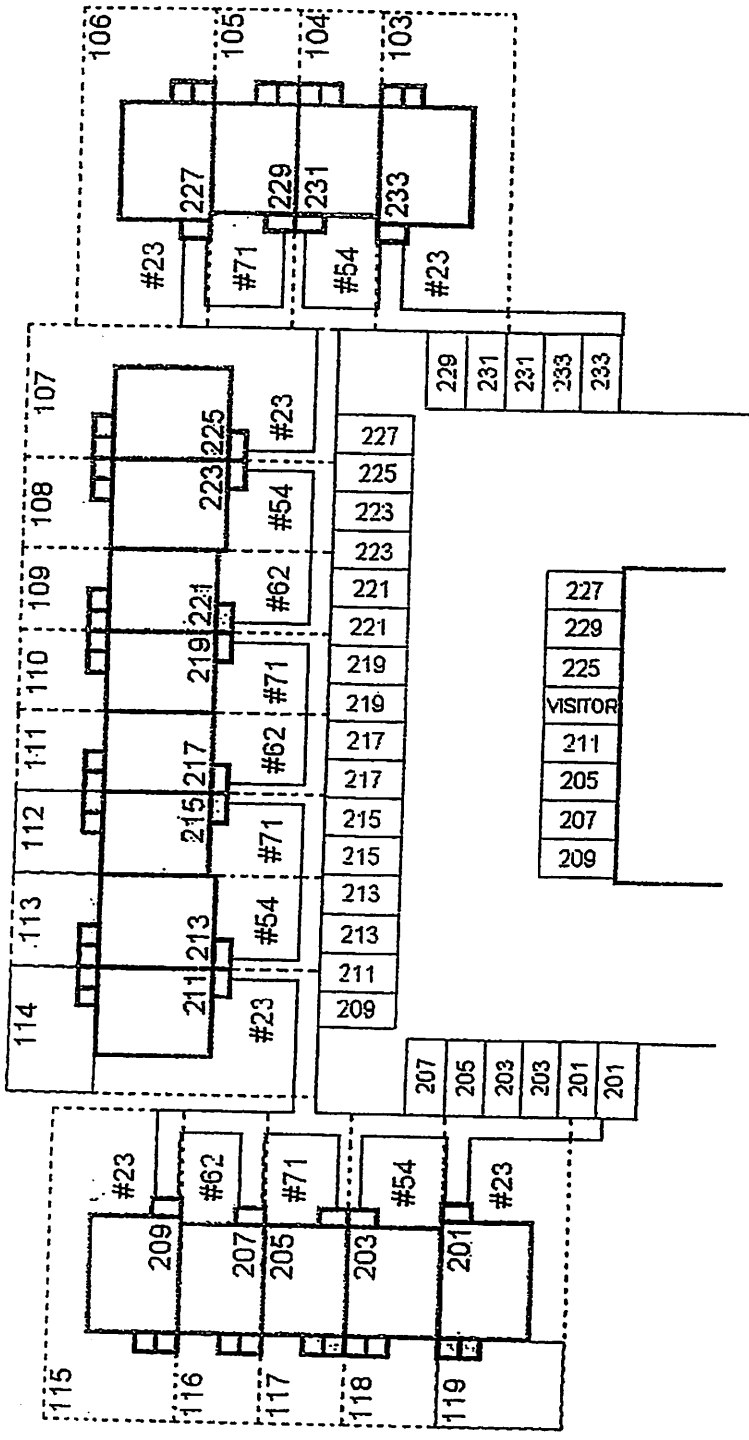

NOTTOWAY DRIVE
CLUSTER #8
 Lots 103 thru 119

17 UNITS - 35 SPACES

July 22, 2005

Homes shown shaded are Owner occupied
 Lots and decks shown shaded are those with
 Board approved fences and decks

3 PIXELS/FOOT

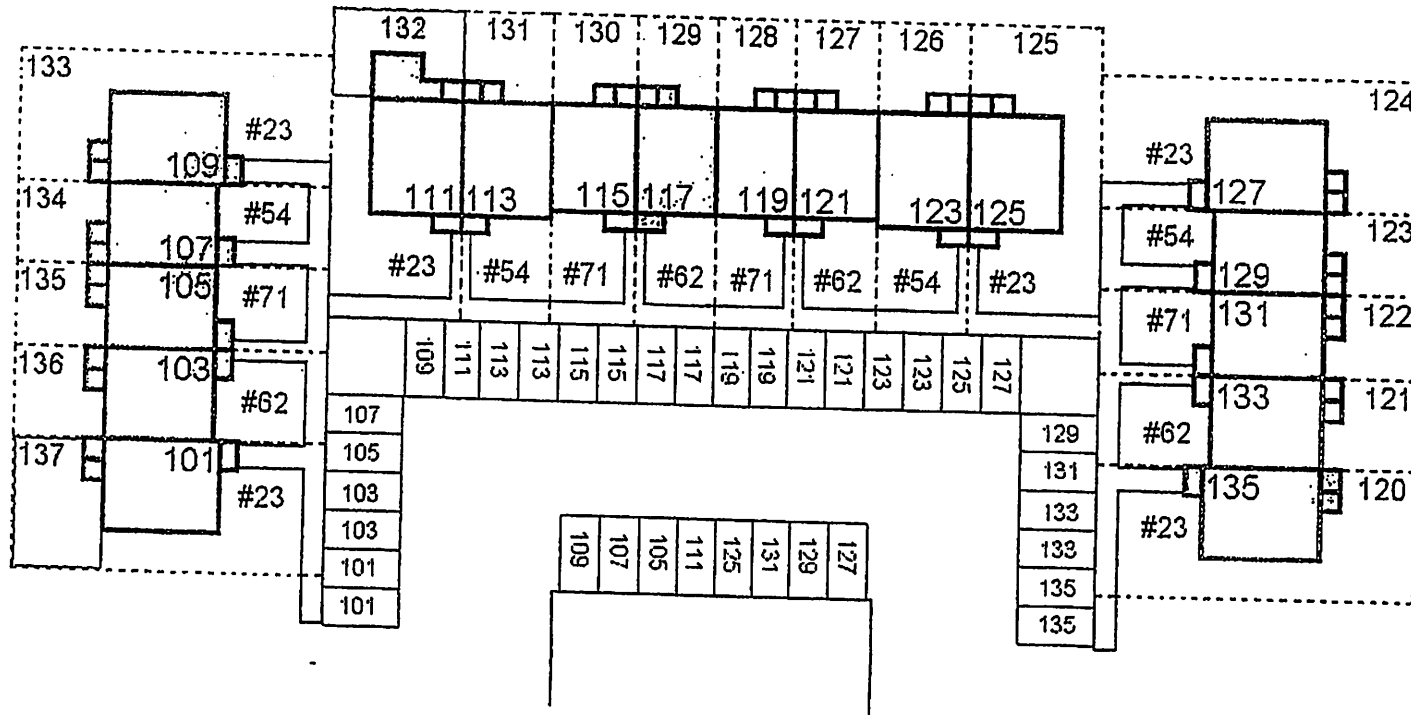

NOTTOWAY DRIVE
CLUSTER #9
 Lots 120 thru 137

18 UNITS - 36 SPACES

July 22, 2005

Homes shown shaded are Owner occupied
 Lots and decks shown shaded are those with
 Board approved fences and decks

3 PIXELS/FOOT